

FS211

LEFOO

Electronic flow switch



Principle, Structure

There are two resistors in the enclosed probe based on the thermal principle. One of them is heated as the detection resistor and the other is not heated. As the reference resistance, when the medium flows, the heat on the heating resistor is taken away. The resistance value is changed, the two resistance differences are used as the basis for judging the flow rate.

Features

No moving parts, maintenance-free, easy to install, one type can meet a variety of diameter requirements. Switching value is continuously adjustable, very low pressure loss, compact structure, LED display flow trends and switch status.

Application

Gas-liquid dual-use type, used for pneumatic and hydraulic systems, circulating water, cutting fluid and lubricating oil flow monitoring, and pump idling protection.

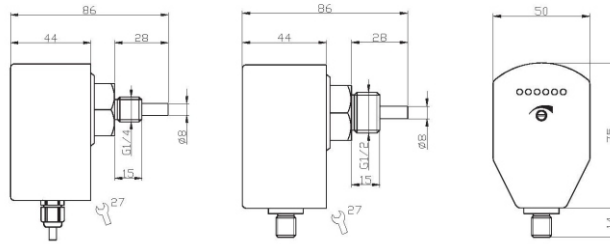

Dimensionless : mm

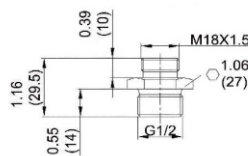

FG12

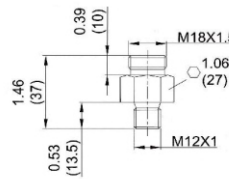

FM12

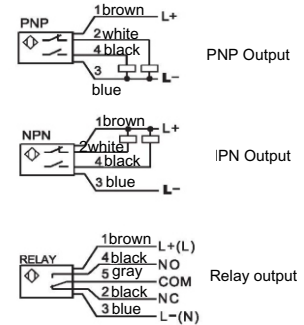

FS211 Order Ref No

FS211-G2-H-D-P-R-Q

1 2 3 4 5 6

1 Pressure Connection	2 Connection Type	3 Power Supply	4 Output	5 Output method	6 Connector Type
G2=G1/2	H=Male	D=VDC24V±20%Power Supply	P=PNP Output	R=NO+NC Output	Q=Socket Connector Type
G4=G1/4			N=NPN Output		
			C=Relay output		

Note: The relay type products need to use 5-pin connector, type and core connector, Just change S (E) T04 to S (E) 05

Socket Connector Order Ref No

ST04-PU-02-F-G

1 2 3 4 5

1 Socket Connector	2 Material	3 Line length	4 Female plug	5 Shape
ST04=M12	PU=PUR	02=2M	F=F	G= Straight type
ET04=M12		05=5M		W= Curved type
		10=10M		

Specification

Setting Range	1...150cm/s(Water),3...300cm/s(Oil),20...2000cm/s(Gas)
Signal output	PNP,NPN,Relay Type,NO+NC
Power Supply	24V±20%DC or 230V±15%DC
Turn on current	Max 400mA(PNP,NPN);Max 4A (Relay Type)
No-load current	Max 80mA
Flow indication	LED (6pcs)
Setting Type	Potentiometer Setting
Proof Pressure Range	100bar
Medium temperature change	≤4°C/s
Response time	1--13s, Typical value 2s
Initialization time	About 8s
Electrical protection	Reverse, short circuit, overload protection
Protection level	IP67
Medium temperature	-20~80°C
Ambient temperature	-20~80°C
Storage temperature	-20~100°C
Connection mode	M12 Socket Connector/Attached 2 meters optional
Material	Probe: stainless steel; Housing: PBT
Weight	About 0.4kg