

LEFOO

LFW10A
TEMPERATURE TRANSMITTER
PRODUCT OPERATION MANUAL



FEATURES

- The shell design is small and beautiful
- A variety of installation methods are optional
- Using the Heraeus A level sensor, high accuracy, fast response speed

OVERVIEW

LFW10A Series temperature transmitter adopts Heraeus A level sensor, high accuracy, fast response speed, good long-term stability, shell design is small, beautiful, has a high level of protection, can be widely used in machine room, HVAC, storage and other places that need temperature detection.

TECHNICAL PARAMETER

Output	PT100/PT1000/NTC20K/NTC10K
Accuracy	Typical 0.2~0.5°C@0/25°C, as the selection table
Housing material	PC housing, stainless steel probe (φ6mm) and sleeving
Working environment	-40~85°C, 0~95%RH(Non-condensing)
IP level	IP65

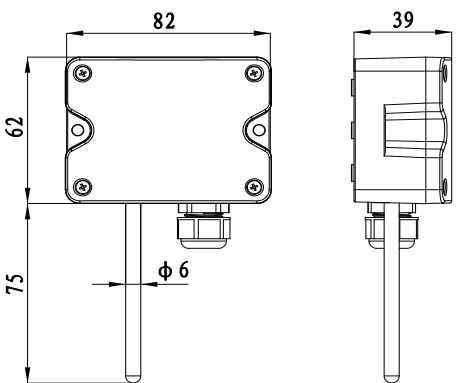

LFW10A-1 Wall-mounted outline drawing

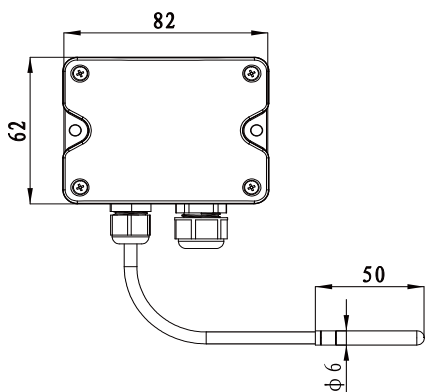

LFW10A-4 Sub-body shape and dimensions diagram

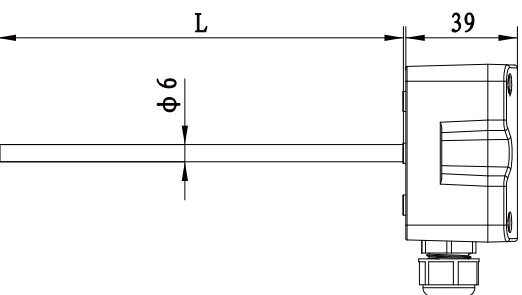
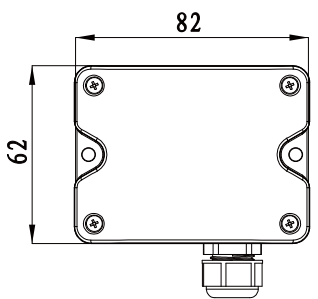

LFW10A-2/10A-3 Dimensions of pipeline type

01

02

03

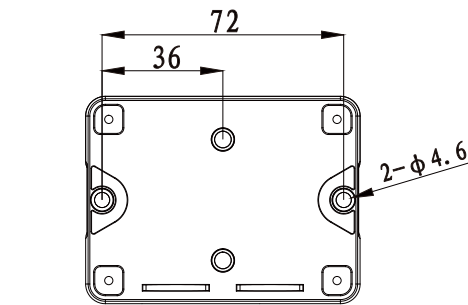
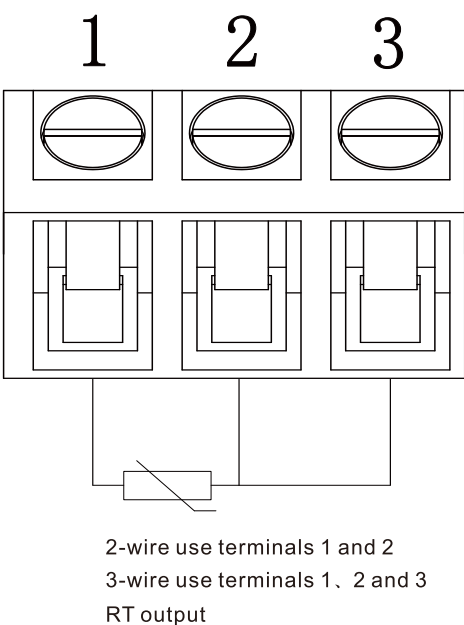

LFW10A-1/10A-4 wall mounting opening

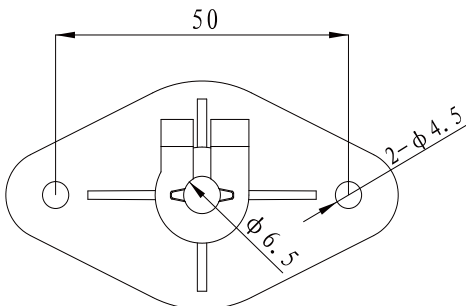

LFW10A-2 Flange mounting opening

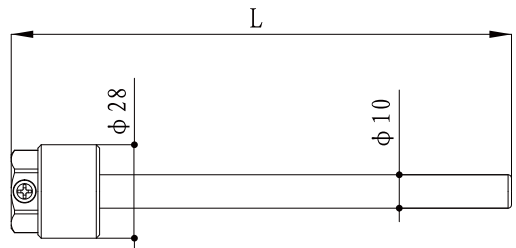

LFW10A-3 Stainless steel casing installation opening

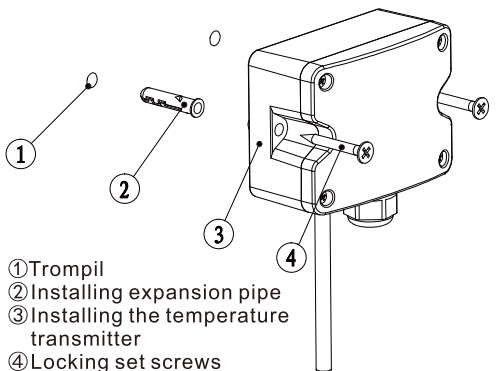

LFW10A-1/10A-4 Installation diagram

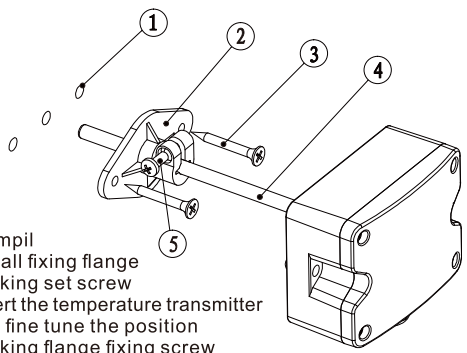

LFW10A-2 Installation diagram

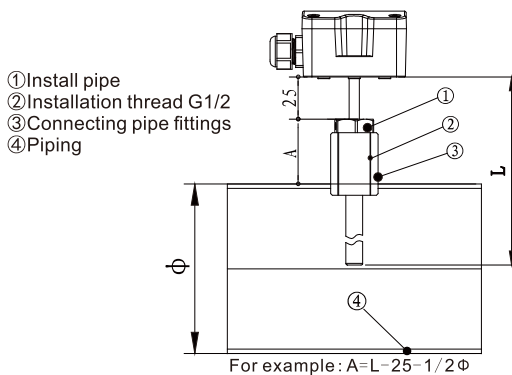

LFW10A-3 Installation diagram

04

05

06

07

INSTALLATION NOTES

1. LFW10A-1/10-4, when select wall-mounted, the probe should be vertically downward. When applied to outdoors, a proper position is needed. Please make sure the transmitter is away from the factors which may affect the measurement, such as cold, heat source, etc. And it's also necessary to install sun visor or protective cover to protect the transmitter from direct sunlight or rain. Drill two holes in the mounting place according to the hole size of the mounting box(refer to above picture), and tighten the mounting box with two screws.

2. LFW10A-2 is recommended to use flange accessories for installation. The insertion depth is adjustable. Fix the flange on the pipe with two screws. The screws can tighten the probe and LFW10A-2. Drilling hole size is 7mm and it must be finally sealed after drilling.

3. LFW10A-3 should be installed with installation joint . The connection joint size should be G1/2 ,and welded to the pipe. Tighten the connection joint to ensure pipe pressure was sealed well. Put in the probe to the pipe bottom, and fasten it with the screws.

4. When wiring, please open the cover and install the waterproof connector first. And then connect the power supply and signal wire at the box base through the waterproof connector. Finish the wiring according to the wiring diagram. In order to make the protection level up to IP65. Please make sure the waterproof connector and the box base matched well without leakage (There is a sealing ring). So do the cover and the bottom box (There is also a sealing ring).

COMMON FAULTS

Fault phenomenon	Cause analysis	Elimination method
The product has no signal output	The output cable of the product is incorrect	Reconnect the cables according to the wiring diagram
Product output fluctuates irregularly	The site environment interference is strong	Use shielded cable